

# Original Operating Manual

## Extractor hood DU3



## Table of Contents

<b>General information</b> .....	<b>3</b>
Limitation of liability .....	3
Responsibilities of the operator .....	3
Documentation .....	4
Content and structure .....	4
Labelling scheme for integrated text boxes and references .....	4
Formatting and symbols .....	5
Service address .....	5
<b>Safety</b> .....	<b>6</b>
Requirements for personnel .....	6
<b>Technical description</b> .....	<b>7</b>
Intended use .....	7
Potential misuse .....	7
<b>Technical data</b> .....	<b>8</b>
<b>Installation</b> .....	<b>9</b>
Setup .....	9
Grease filter .....	9
Connection to a laboratory oven .....	10
Rating plate .....	10
Assembly drawing .....	11
<b>Transport, packaging and storage</b> .....	<b>12</b>
Transport .....	12
Packaging .....	13
Storage .....	13
<b>Care and maintenance</b> .....	<b>14</b>
<b>Decommissioning</b> .....	<b>15</b>
<b>Disposal</b> .....	<b>15</b>
Safety .....	15
Disposal .....	15

## General information

### Limitation of liability

The contents of this operating manual were created taking the applicable laws and standards into account.

The unit was developed using state-of-the-art technology.



#### NOTICE

**The manufacturer assumes no liability for damage resulting from:**

- Disregard/non-observance of the operating manual
- Intentional misuse
- Use other than as intended
- Operation by untrained personnel
- Operation by non-professionals (carrying out maintenance work, etc.)
- Technical modifications to the unit that were not agreed with the manufacturer
- Use of replacement parts that were not approved by the manufacturer

### Responsibilities of the operator

The unit is used for commercial purposes. The operator of the unit is therefore subject to the statutory obligations relating to occupational safety. In addition to the safety instructions in this operating manual, the regulations on safety, accident prevention and environmental protection that apply to the unit's area of application must be complied with.

**In particular, the following apply:**

- The operator must be familiar with the applicable regulations on occupational safety.
- The operator must ensure that all employees who use the unit have read and understood this operating manual.
- The operator must also train personnel at regular intervals, and inform them of the dangers that can arise when using the unit.
- The operator must provide personnel with the necessary protective equipment.
- The operator must have all safety devices checked regularly for operability and completeness.

## Documentation

### Content and structure

This operating manual is an essential part of this unit. It contains instructions and information on how to use the unit safely and must be available to all users throughout the unit's service life. This operating manual is intended for use by trained operating personnel.

### Labelling scheme for integrated text boxes and references

The following safety notices are used in this manual:



#### **DANGER**

Indicates an imminent danger that may cause serious physical injury or death.



#### **WARNING**

Indicates a potentially dangerous situation that may cause serious physical injury or death.



#### **CAUTION**

Indicates a potentially dangerous situation that may cause minor physical injury.



#### **NOTICE**

Indicates a potentially harmful situation in which the product or an object in its vicinity may be damaged.

#### **NOTICE**

Information or tips for easier operation.

## Formatting and symbols

- § indicates a general safety instruction
- ☑ indicates that a requirement must be met
- 1. indicates a step to be carried out
- ➔ indicates the outcome of carrying out a step
- indicates a list
- S1** indicates a button

## Service address



Friedrich-List-Straße 8  
76297 Stutensee-Blankenloch, Germany  
Tel.: +49 (0) 7244 70871-0  
[www.mihm-vogt.de](http://www.mihm-vogt.de)

## Safety

The **Extractor hood DU3** is an extractor hood for commercial use in dental laboratories and may only be used as intended.

### Requirements for personnel

Trained and qualified personnel who know how to use the unit and whose specialist training, skills, experience and knowledge of the relevant regulations enables them to carry out the tasks assigned to them independently and recognise and avoid potential hazards.



### DANGER

#### Electricity!

Risk of death from electric shock.

- Do not touch live cables and components with wet hands.
- Observe the accident-prevention regulations when working with electric current.
- Before carrying out any installation, maintenance, cleaning or repair work, disconnect the power supply from the **Extractor hood DU3** and secure it against being switched back on.



### CAUTION

#### Incorrect operation!

No liability is assumed for damage that may be caused by misuse, incorrect operation, incorrect connections or improper maintenance/repair work carried out by untrained personnel. All warranty services are also excluded in such cases.

The unit must not be used if it or the mains cable becomes damaged and no longer functions correctly.

In this case, contact the manufacturer immediately.

For your own safety and to increase the service life of your unit, use only original replacement parts.

To ensure safe operation of the **Extractor hood DU3**, regional regulations (e.g. accident-prevention regulations) apply in addition to the instructions in this operating manual. The former must be made available by the operator of the unit.



### NOTICE

This operating manual must be read and understood by each user before working on and with the unit.

The operating manual must be kept for the specified service life of the **Extractor hood DU3**.

## Technical description

### Intended use

The **Extractor hood DU3** is used for extracting harmful vapours that may result during sintering processes.



#### NOTICE

The protection of persons can no longer be ensured and no liability can be assumed for damage that is caused by misuse, incorrect operation, incorrect connections or improper maintenance/repair work carried out by untrained personnel. All warranty services are also excluded in such cases.

The use of spare and wearing parts that have not been procured from the manufacturer will render the approval and warranty for the **Extractor hood DU3** null and void.

### Potential misuse

- Operation by untrained and insufficiently qualified personnel.
- Use of products that were not approved by the manufacturer.
- Use of replacement parts that were not approved by the manufacturer.
- Any use not in accordance with the declaration of conformity.
- Technical modifications to and conversions of the unit that were not approved by the manufacturer.



#### NOTICE

Only wearing and spare parts approved by Mihm-Vogt may be used.

You can find an overview of the approved components on the supplementary sheet in your device packaging.

## Technical data

General information	DU3/2	DU3/3
Dimensions [mm] (W x D x H)	1200/700/400	1800/700/400
Weight [kg]	47 kg	54 kg
Extraction capacity/min.		20 m <sup>3</sup> /min.
Extraction pipe Ø		140 mm
99h timer		✓
Grease filter		✓
Connected electrical load		
Voltage supply		230 V
Mains frequency		50 Hz
Max. power consumption		370 W

✓ = standard ● = optional ∪ = optional with reservation ✕ = not compatible

## Installation

### Setup

The extractor hoods are mounted on a solid wall with screws Ø 6mm in conjunction with a dowel system suitable for the type of wall. The extractor hoods of type DU3/2 and DU3/3 are provided with a connecting cable and mains plug as standard and intended for connection to a protective earth socket.

The blow-out opening must be extended using standard metal pipes with 140 mm diameter. The 140 mm diameter must be retained along the extension and must never become less. The extraction pipe must always be kept clean to ensure that the extractor hood works properly.

The extraction pipe is controlled via the integral speed regulator. The most powerful extraction power is set immediately after switching on. This can be reduced appropriately by the turning the setting wheel further.

The hole pattern (Seite 11) is for a DU3/2 extractor hood. For extractor hood DU3/3, the hole pattern is extended by one field in the same way.

### Grease filter

The extractor hood is equipped with a grease filter. Depending on requirements, this grease filter can be removed and cleaned with a steam jet cleaner. To do this, the baffle plate must be lifted out and the wing nuts unscrewed on the motor box. The grease filter can then be removed.

## Connection to a laboratory oven

The extractor hood is connected to the rear socket of an MIHM-VOGT laboratory oven for automatic operation. You can read about how to program the control in the corresponding operating manual for the laboratory oven.

If you would like to operate the extractor hood automatically at several laboratory ovens, an MIHM-VOGT oven adapter of type OA2 (or OA3, OA4, for 2, 3 or 4 ovens) must be connected between the individual ovens and the extractor hood.

## Rating plate



Abb. 1: Rating plate (example)

- |   |                          |    |                                       |
|---|--------------------------|----|---------------------------------------|
| 1 | Machine type/designation | 6  | Reference number Mihm-Vogt            |
| 2 | Operating voltage        | 7  | Serial number                         |
| 3 | Mains frequency          | 8  | Year of manufacture                   |
| 4 | Power                    | 9  | Manufacturer details                  |
| 5 | CE mark                  | 10 | "Disposal as per EC 202 / 96 EC" mark |

# Assembly drawing

### Assembly of type DU3 extraction hoods

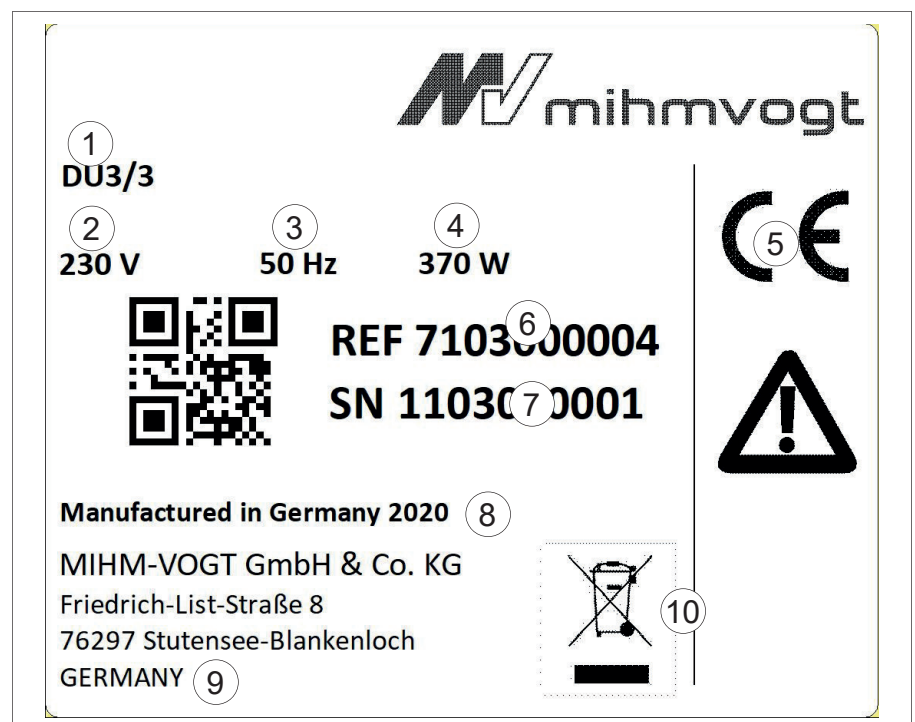
For attachment, please use  $\varnothing$  6mm screws in conjunction with a dowel system suited to the wall type.

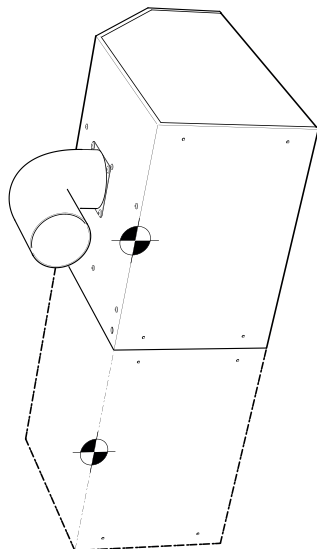

### Positioning

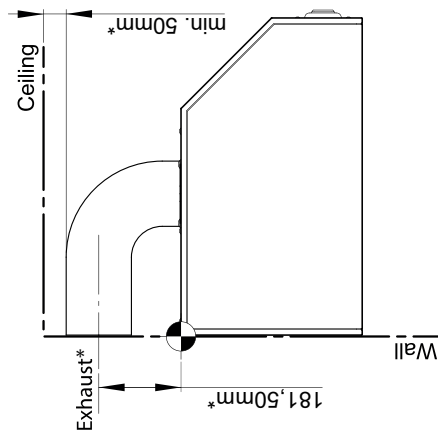

### Drilling pattern

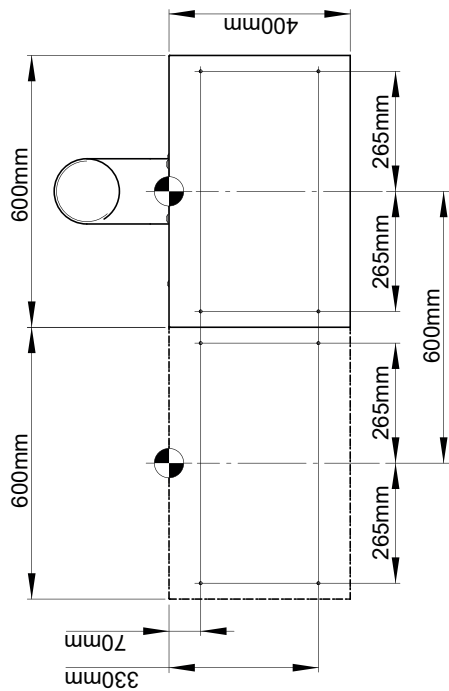

Reference point / datum for all dimensions

\* These dimensions depend on the pipe material used.

Additional elements can be set up next to the main element (see below left).

### Extension options:

2 units, extraction element on the left

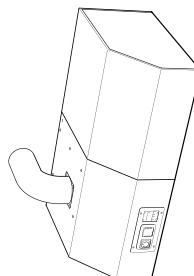

2 units, extraction element on the right

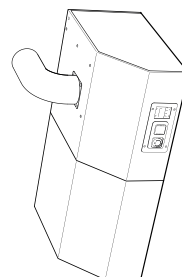

3 units, extraction element on the left

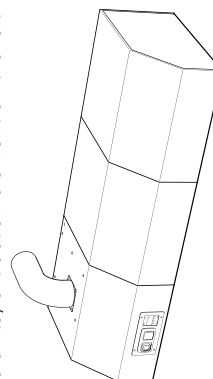

3 units, extraction element in the middle

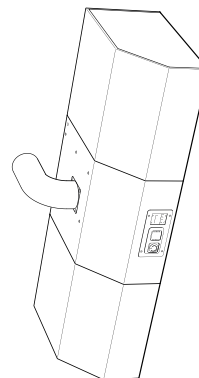

3 units, extraction element on the right

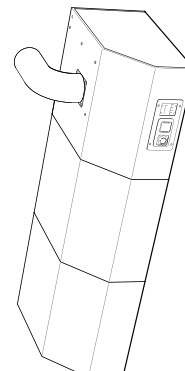

### Exhaust alignment...

...to the rear

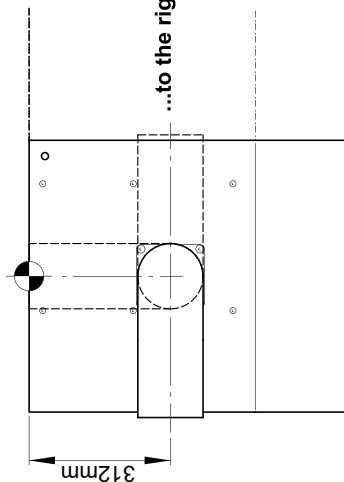

# Transport, packaging and storage

## Transport



### NOTICE

#### Transport damage!

To prevent injury to personnel and material damage:

- Transport the unit in an upright position only.
- Do not stack units on top of each other.
- Do not place any other objects on the unit.
- Transport must be as free of shaking and vibrations as possible to prevent the unit from being damaged.
- Make sure that the unit is secured against slipping and falling during transport.
- If necessary, gloves (against slipping and cut injuries) as well as safety shoes (against foot injury upon falling) must be worn when carrying the device.
- The goods must be inspected for damage and loss immediately upon receipt. Defects must be documented by the freight carrier on the letter of consignment in order to lodge claims. **Mihm-Vogt GmbH & Co.KG** assumes no liability for any damage and loss that is only found subsequently.

## Packaging



### NOTICE

The packaging protects the **Extractor hood DU3** against transport damage, corrosion and other forms of damage. Only remove it shortly before initial commissioning, and store it in dry conditions for later reuse.

## Storage



### NOTICE

#### Temperature damage!

To prevent temperature damage:

- Always store the unit in dry and dust-free conditions.
- Avoid exposure to direct sunlight.
- Avoid mechanical vibrations.

## Care and maintenance

Clean the housing of the *Extractor hood DU3* every so often with a damp cloth.

Make sure that the motor and blow-out nozzle are free of any dirt to ensure that it works properly. The extractor hood does not otherwise require any special maintenance.

## Decommissioning

Decommissioning can be carried out for two reasons:

- For the purpose of reinstalling the unit at another location.
- For the purpose of final disposal.

If the **Extractor hood DU3** is to be reinstalled at another location, decommissioning must be well prepared. All components and fittings must be carefully removed, labelled and, if necessary, packaged for transport. This ensures that all parts can be identified correctly and refitted in the correct positions when reassembling the unit.

1. Switch the **Extractor hood DU3** off.
2. Disconnect the **Extractor hood DU3** from the voltage supply.
3. Remove all connections from the **Extractor hood DU3**.

## Disposal

### Safety



### WARNING

**Potential contamination of the environment and groundwater due to improper disposal!**

- The regulations and guidelines of the legislature in the country of operation must be complied with when disposing of parts of the unit and operating materials.

### Disposal

1. Sort the component parts of the **Extractor hood DU3** into recyclable materials and operating materials.
2. Dispose of the component parts of the **Extractor hood DU3** or take them to be recycled.



